

ON DISPLAY

# Melody Kurmond Homes

5 3 2

**Base price** \$398,400  
**View** Webber Loop, Oran Park  
**Open** Daily 10am-5pm  
**Phone** 1300 764 761  
**Web** kurmondhomes.com.au  
**Area** 437.50m<sup>2</sup> **Width** 15.46m  
**Depth** 20.63m **Facades** 3  
**Alfresco** Included



The Melody 43 hits a high note from the moment you first lay eyes on it.

Recently completed at Oran Park in Sydney's southwest, the five-bedroom house is light filled and spacious with plenty of living spaces to enjoy.

The Cosmopolitan facade provides a smart first impression and then skylights along the two-storey high void entry allow natural light to flood in setting the bar for what's to come.

There's a guest room to one side with a large walk-in robe and a home theatre behind, a spacious room with a sliding door.

At the rear there's a kitchen, spacious dining area and family room, plus two sets of sliding doors leading to a large alfresco area.

An inviting two-way fireplace, between the family room and kitchen, breaks up the space.

Running behind the kitchen is a scullery with a double-basin sink, plus a walk-in pantry, with shelves on two sides.

The central stairway with its blend of timber and glass, adjoins the two-storey void.

Upstairs there are four bedrooms, with the retreat-like master bedroom having direct access to the home's back balcony.

The three remaining bedrooms are all a good size and each has a walk-in robe.

**Words** Jennifer Veerhuis  
**Pictures** Bob Barker

## What the builder says

“ This family home makes people believe that designer homes are within their reach. Australian hardwood and stone in combination with Alucobond (aluminium composite material) and render have given this facade a very enticing look. The natural light through the use of skylights and the voided entry showcases the open-style plan. The heart of this home is our living, alfresco and kitchen area. ”

**Peter Kulakovski** Kurmond Homes managing director



The stylish kitchen is a home chef's dream with a scullery and walk-in pantry in addition to a deep island benchtop and ample storage



NEW HOME



we're loving THE USE OF NATURAL LIGHT WITHOUT COMPROMISING PRIVACY

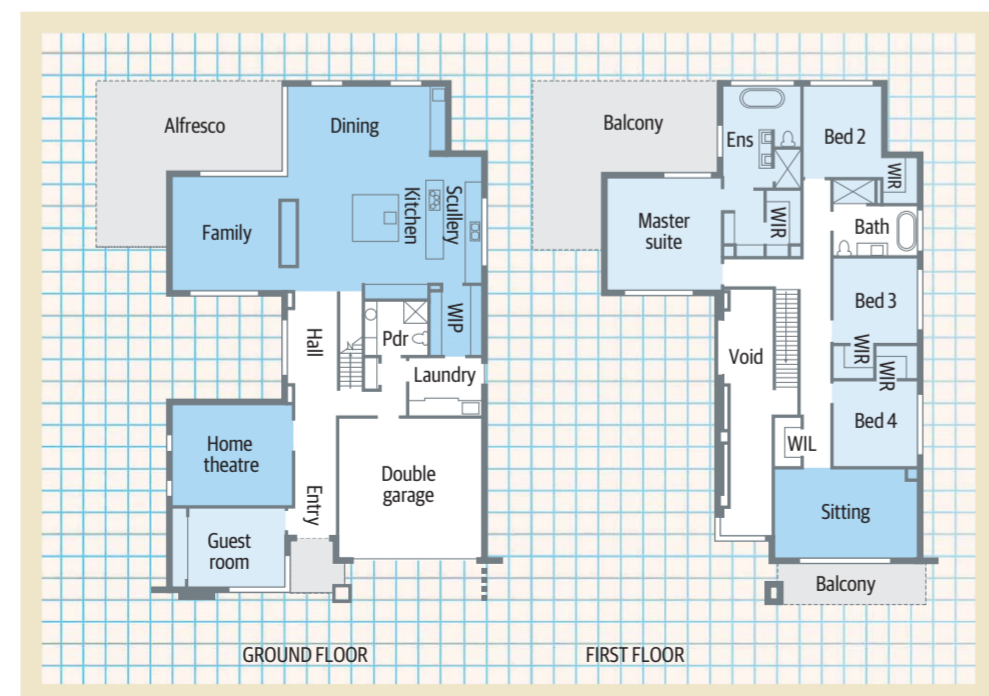
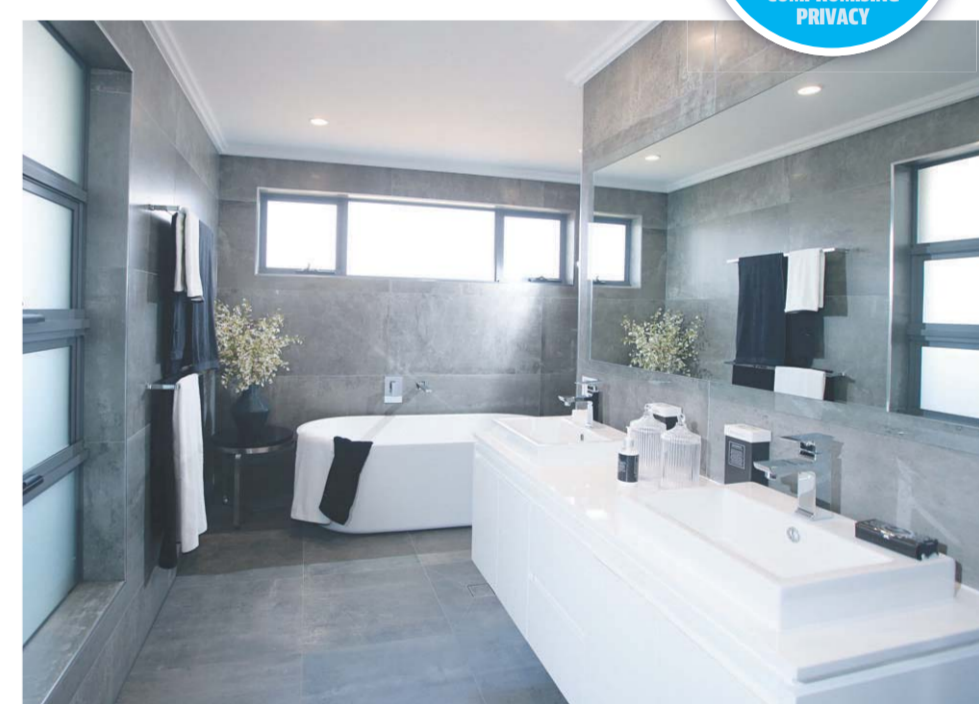

**In the market**  
“ We couldn't fit the Sierra on our block of land at Gledswood Hills but Kurmond Homes worked closely with us, reducing the width and adding to the length of the home. They gave us every opportunity to get it exactly the way we wanted. When you walk in, you see a nice main bedroom, then the step-down cinema. It really is well-presented, everything is just in the right place. ”  
**Dorothy and George Adam**

**HOME BUILDERS DIRECTORY**  
MORE NEW HOME DESIGNS  
dailytelegraph.com.au/lifestyle/home-mag